

PLAN
SCALE: 1" = 30'

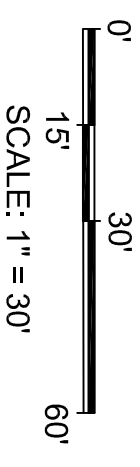

PROPOSED BRIDGE
180'(L) x 28'(W), 20°SKEWNESS
DECK ELEV. 231.5'
LOW CHORD ELEV. 228.0'

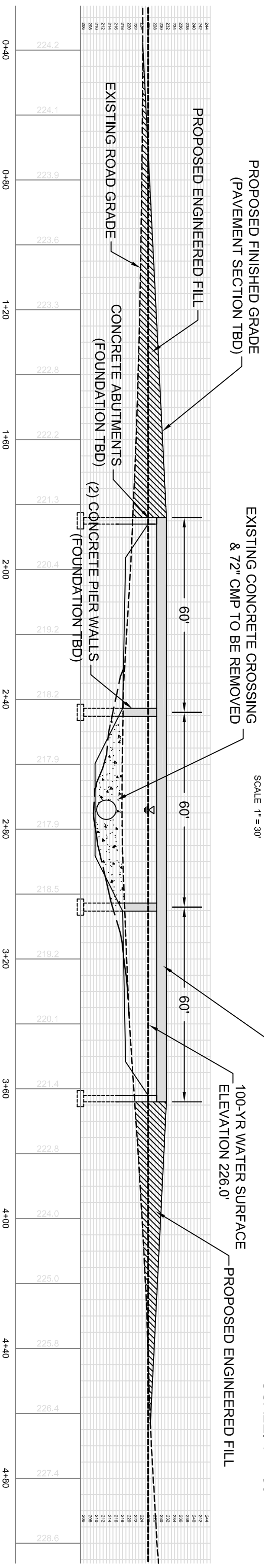

PROFILE
SCALE (HORIZ./VERT.): 1" = 30'

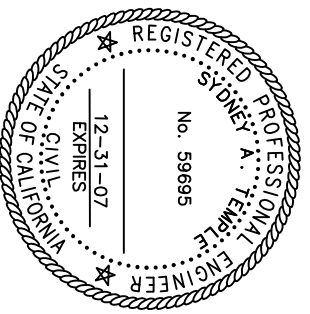

TRI COUNTY FISH TEAM
FISH PASSAGE IMPROVEMENTS

Date: 03-15-07
Drawn: J.M.
Appr'd: S.T./J.P.
Dwg. No: 240234-Concept_V3.dwg



PROPOSED BRIDGE CROSSING
ARROYO GRANDE CREEK
AT CECCHETTI ROAD
SAN LUIS OBISPO COUNTY